

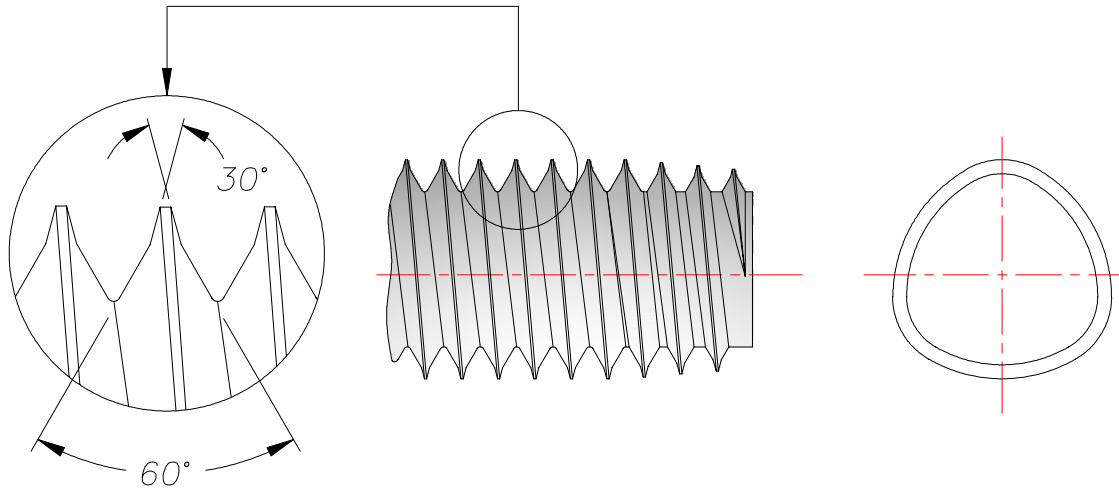

POWERLOK® Fasteners

All Metal Locking Fasteners



POWERLOK® TRILOBULAR® All Metal Locking Fasteners Solve Assembly Difficulties and Reduce Your In-Place Fastening Costs

POWERLOK® Geometry

Thread Profile:

The innovative Dual-Angle™ thread form provides "live-action" locking.

The spring action of the thread tip creates classic "stored energy" locking.

Interferes in the root of the nut thread. Locking is not affected by an incomplete internal thread form.

TRILOBULAR® Body:

Capitalizes on elastic memory of nut member.

Further prevents vibrational loosening by providing additional locking action.

Reduces friction during installation.



Spring action of the Dual-Angle™ Thread Profile

POWERLOK® Advantages

- No need for patches, adhesives or assembly line applied locking compounds.
- Locking action is over the entire length of the screw thread.
- Locking action is not affected by temperature.
- No curing time—instantaneous locking action.
- No need for under head locking elements.
- No need for costly lock washers.
- Works with all finishes.
- Easily hand started.



POWERLOK® Fasteners

All Metal Locking Fasteners

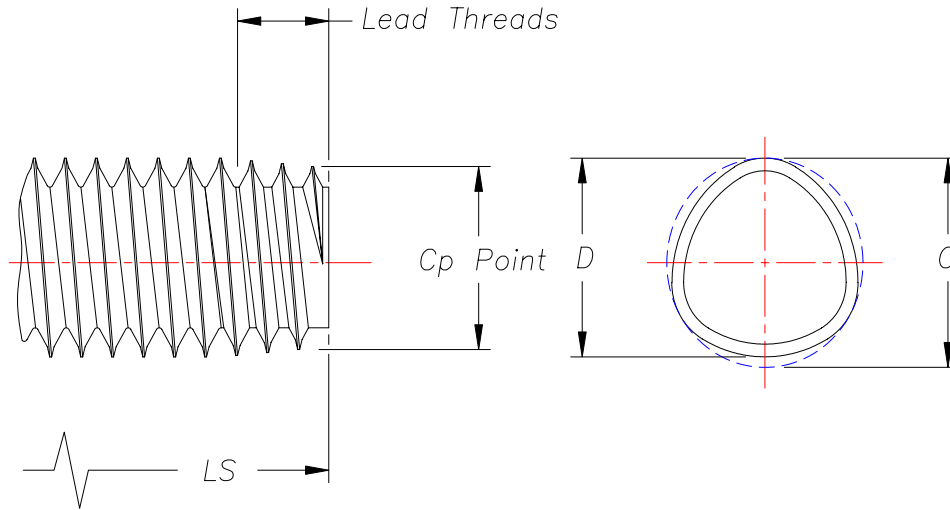

Inch Series

Screw Size	Screw Body				Point Cp Max.
	C		D		
	Max.	Min.	Max.	Min.	
4-40	0.117	0.112	0.112	0.107	0.112
5-40	0.131	0.125	0.126	0.120	0.125
6-32	0.147	0.141	0.141	0.135	0.138
8-32	0.173	0.167	0.167	0.161	0.164
10-24	0.205	0.198	1.970	0.190	0.190
10-32	0.200	0.193	0.194	0.187	0.190
12-24	0.231	0.224	0.223	0.216	0.216
1/4-20	0.270	0.262	0.260	0.252	0.250
1/4-28	0.263	0.255	0.256	0.248	0.250
5/16-18	0.332	0.324	0.321	0.313	0.312
3/8-16	0.395	0.387	0.382	0.374	0.375
7/16-14	0.460	0.452	0.446	0.438	0.437
1/2-13	0.524	0.516	0.508	0.500	0.500

Metric Series

Screw Size	Screw Body				Point Cp Max.
	C		D		
	Max.	Min.	Max.	Min.	
M2.0 x 0.40	2.15	2.05	2.07	1.97	2.0
M2.5 x 0.45	2.66	2.56	2.57	2.47	2.5
M3.0 x 0.50	3.18	3.08	3.08	2.98	3.0
M3.5 x 0.60	3.69	3.59	3.57	3.47	3.5
M4.0 x 0.70	4.22	4.10	4.08	3.96	4.0
M5.0 x 0.80	5.26	5.13	5.10	4.97	5.0
M6.0 x 1.00	6.30	6.15	6.10	5.95	6.0
M8 x 1.25	8.35	8.20	8.10	7.95	8.0
M10 x 1.50	10.40	10.25	10.10	9.95	10.0
M12 x 1.75	12.45	12.30	12.10	11.95	12.0

** Common sizes listed, other sizes available.

Length Tolerance - Inch - Per ANSI B18.6.3

Nominal Screw Length	Nominal Screw Size	
	#4 - #12	1/4" - 1/2"
	Tolerance On Length	
To 1/2" Inclusive	+0, - .020	+0, - .030
Over 1/2" to 1" Inclusive	+0, - .030	+0, - .030
Over 1" to 2" Inclusive	+0, - .060	+0, - .060
Over 2"	+0, - .090	+0, - .090

Length Tolerance - Metric Per ANSI B18.6.7M

Nominal Screw Length	Tolerance on Length mm
to 3mm incl	± 0.2
over 3 to 10mm	± 0.3
over 10 to 16mm	± 0.4
over 16 to 50mm	± 0.5
over 50mm	± 1.0

Research Engineering & Manufacturing Inc.

55 Hammarlund Way, Tech II
Middletown, RI 02842, U.S.A.
Tel: (401) 841-8880
Fax: (401) 841-5008

reminc@reminc.net • www.taptite.com



Conti Fasteners AG

Albisstrasse 15 • CH-6340 Baar
Switzerland
Tel: +41(0) 41/761 58 22
Fax: +41(0) 761 3018

reminc@reminc.net • www.taptite.com